

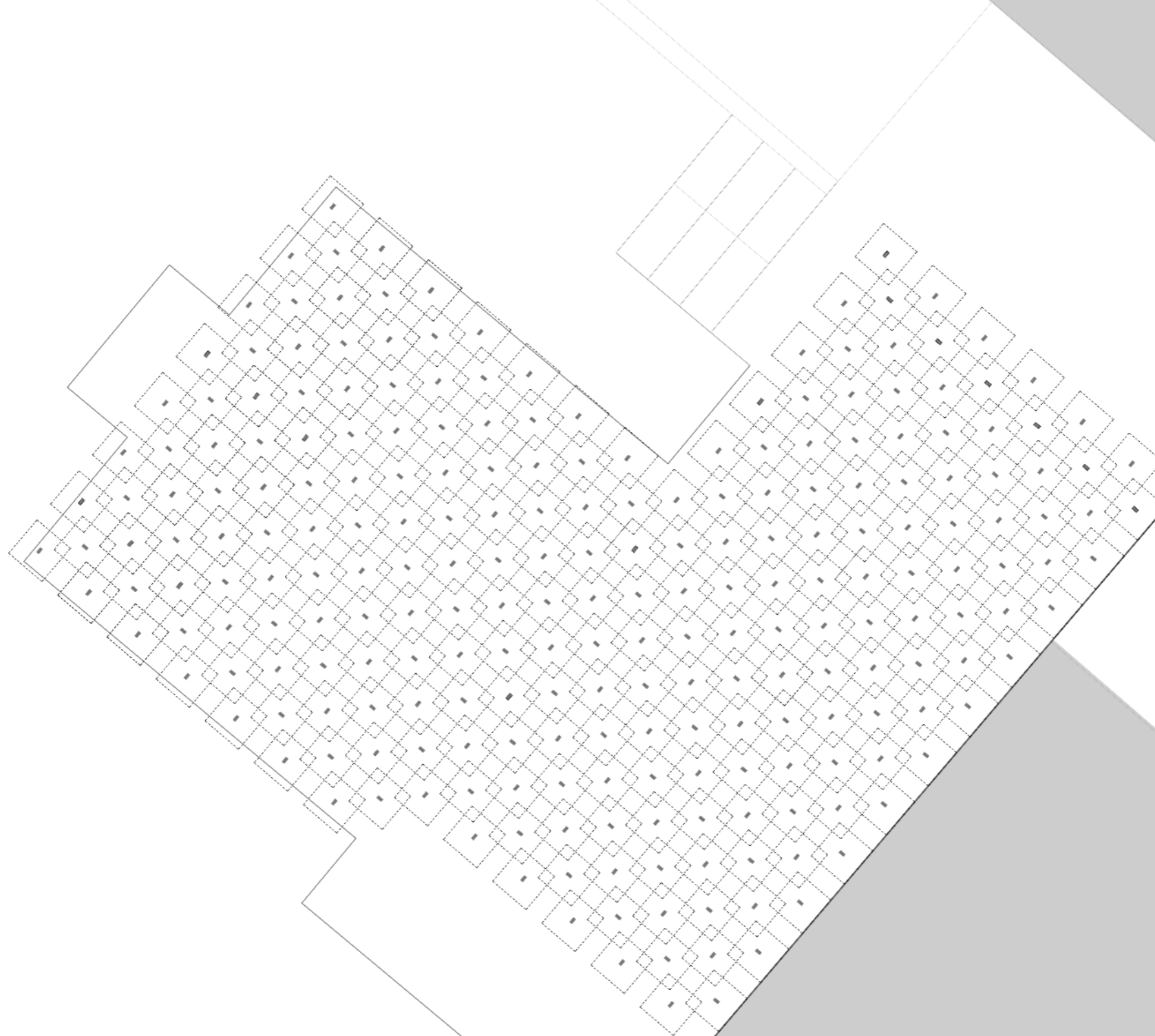

VIENS APPORTER TA CROIX À L'ÉDIFICE !

CAB' RILLE





*Programme et expression architecturale*

BARTH Vincent  
BALLESTER Julia  
COTTON Ines  
CRUELLS Renaud  
DURAND Thomas  
KHAUV Daniel

MARTÍNEZ PÉREZ Pol  
MESTRE Antoine  
NIU Chenxiang  
LIER Keryann  
PIHAN Juliette

M. LEYRAL - F. MARTINET  
**Sculpture Technotnique 2017/18**

**CAB'RILLE**

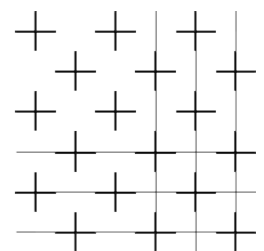

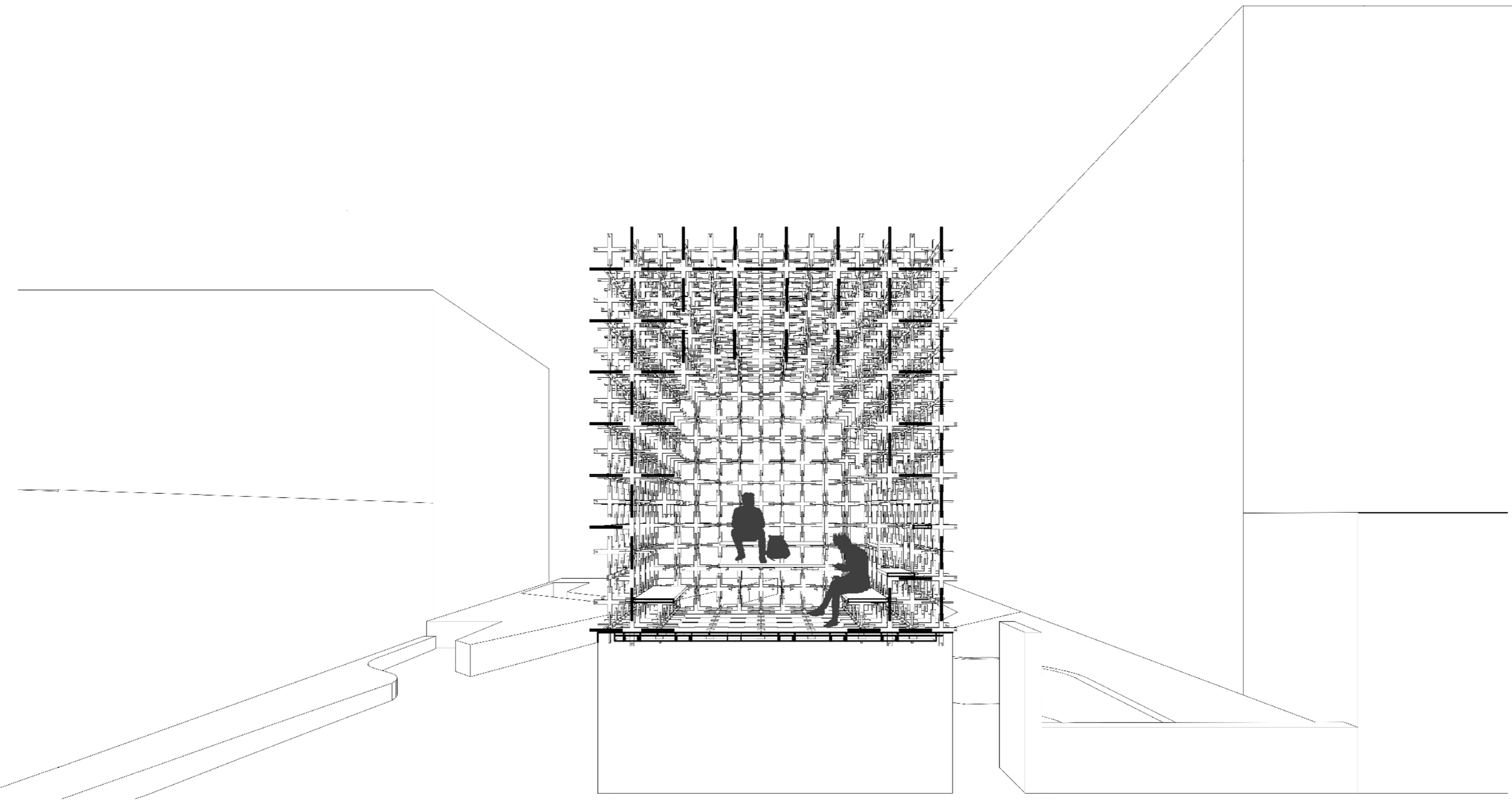

*Programme et expression architecturale*

BARTH Vincent  
BALLESTER Julia  
COTTON Ines  
CRUELLS Renaud  
DURAND Thomas  
KHAUV Daniel

MARTÍNEZ PÉREZ Pol  
MESTRE Antoine  
NIU Chenxiang  
LIER Keryann  
PIHAN Juliette

M. LEYRAL - F. MARTINET  
**Sculpture Technotnique 2017/18**

**CAB'RILLE**

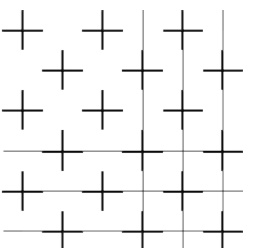

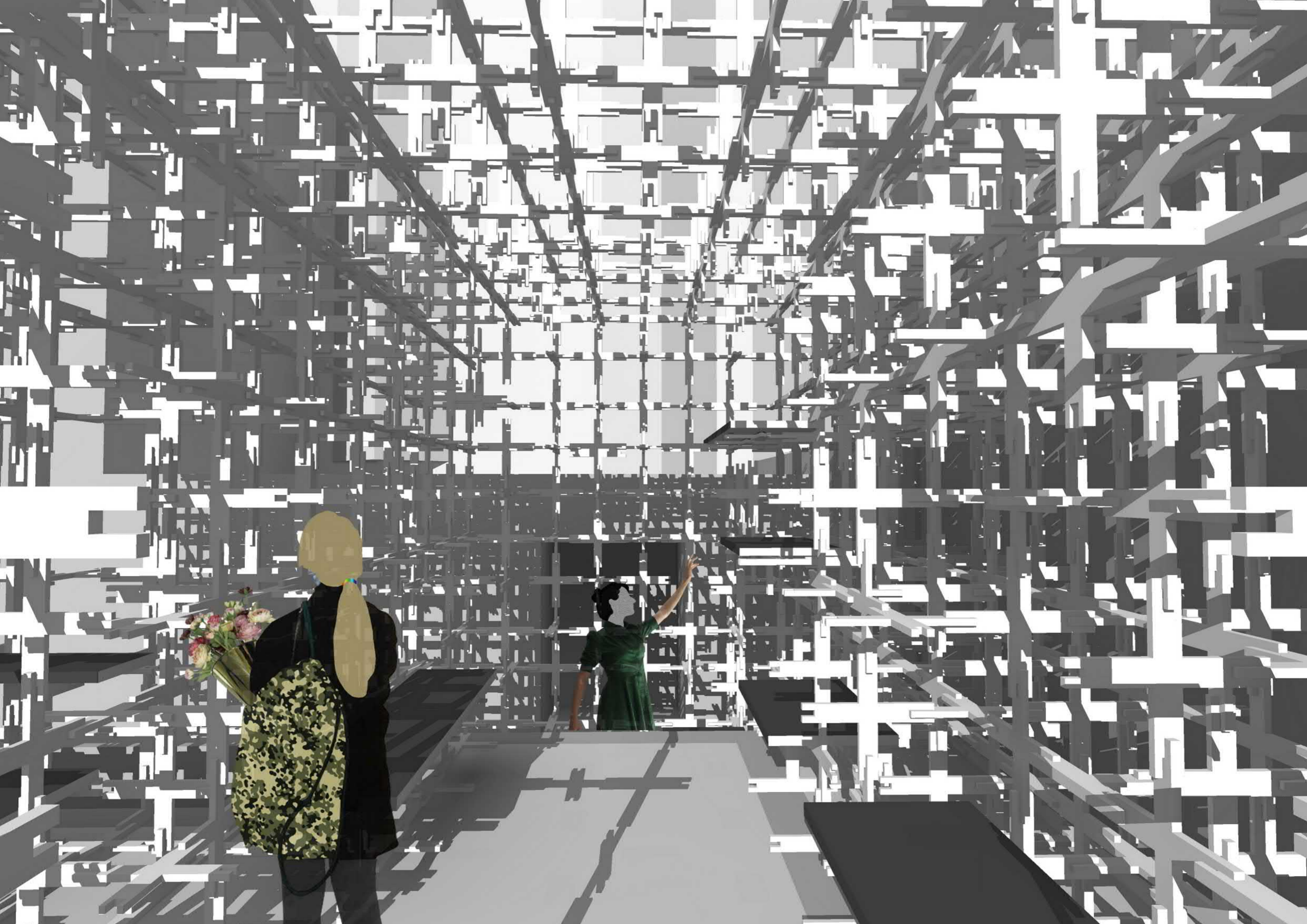

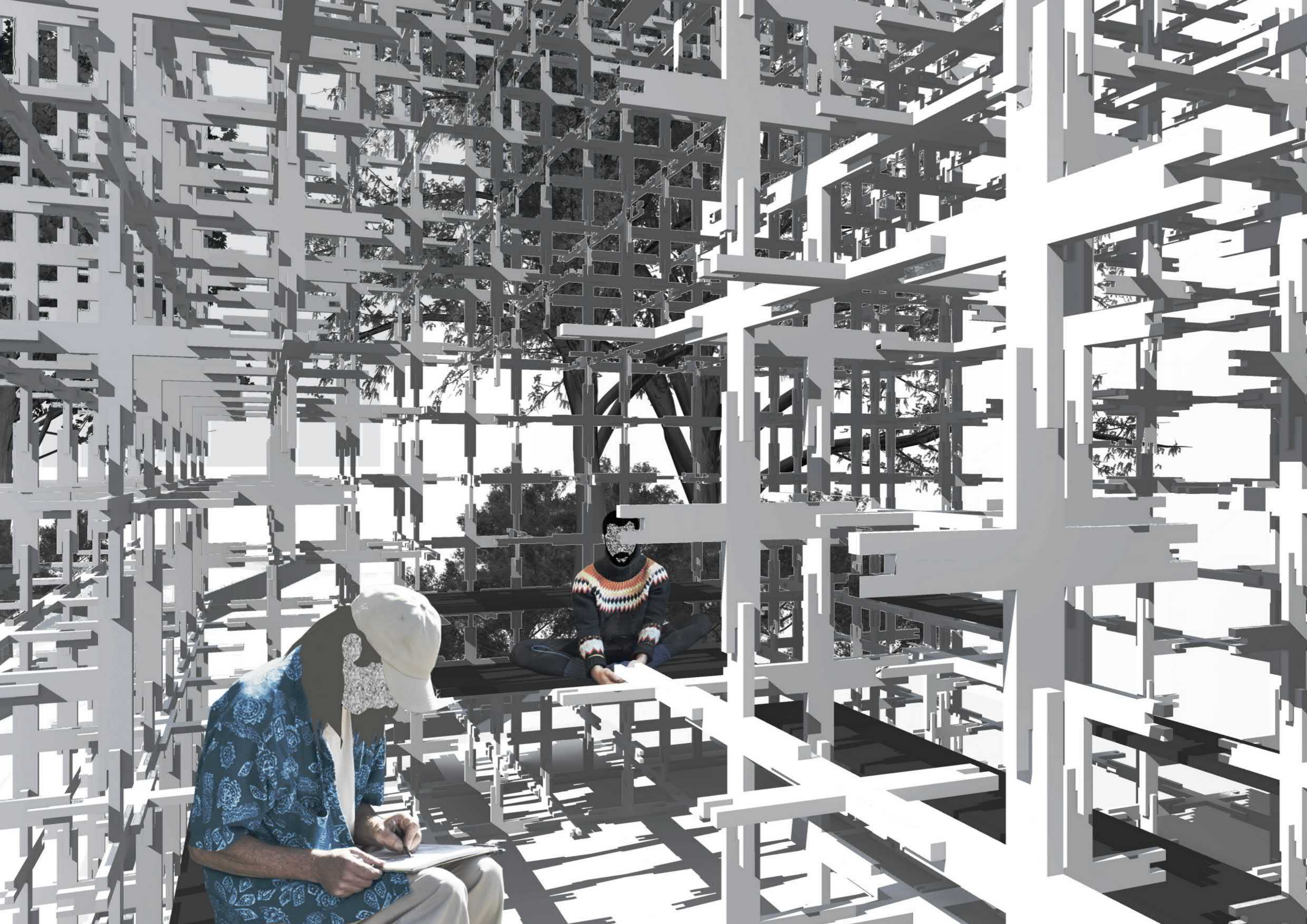

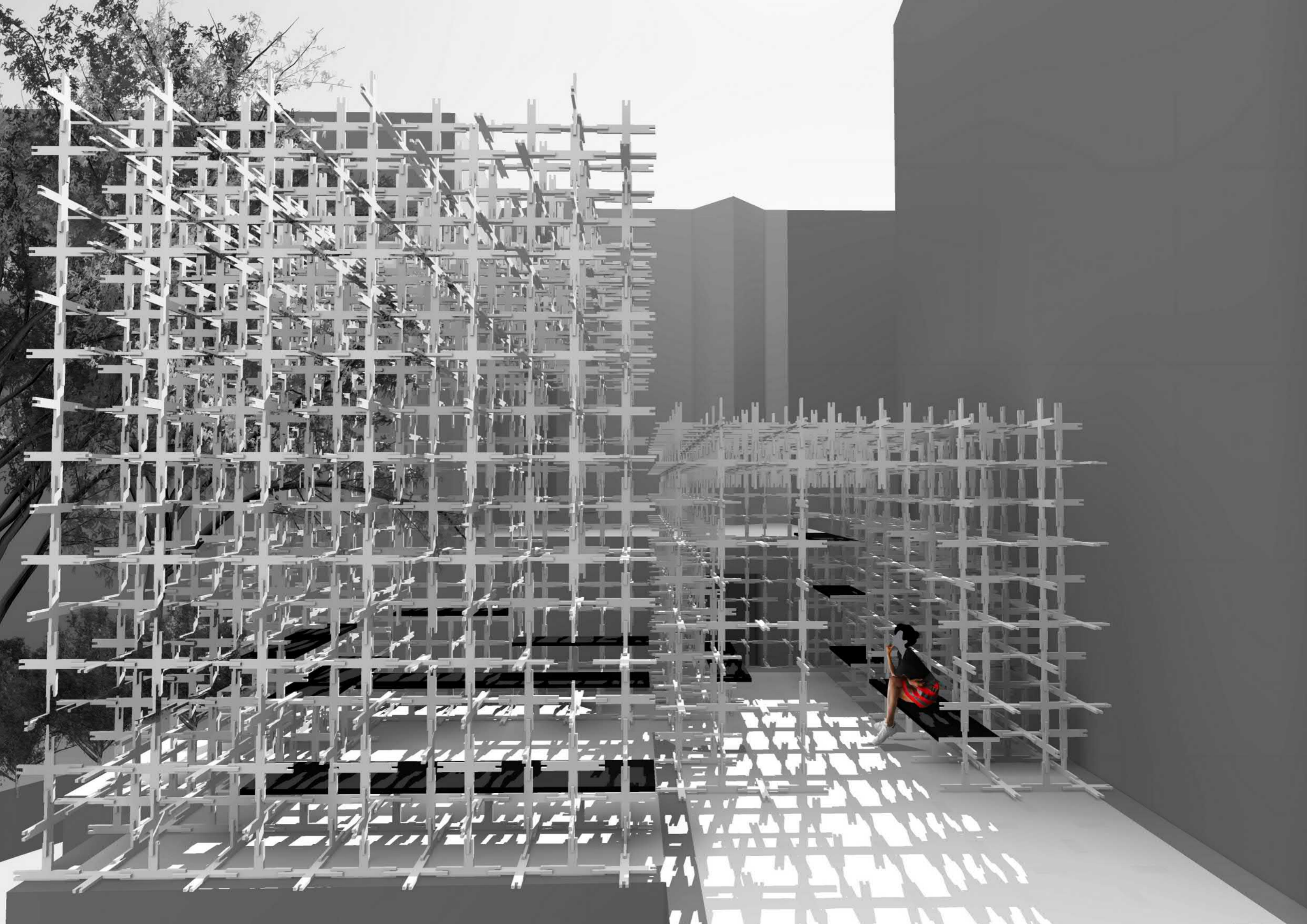

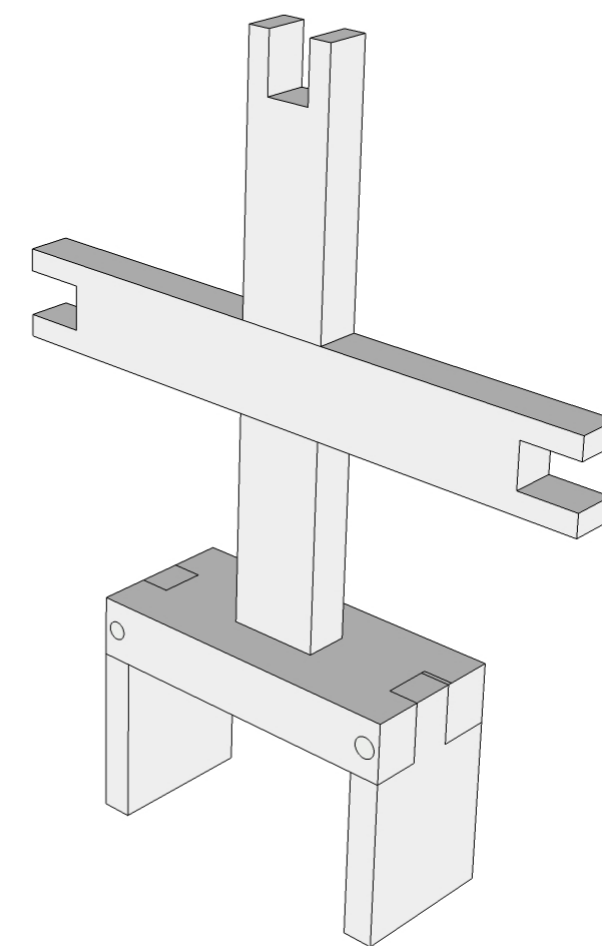
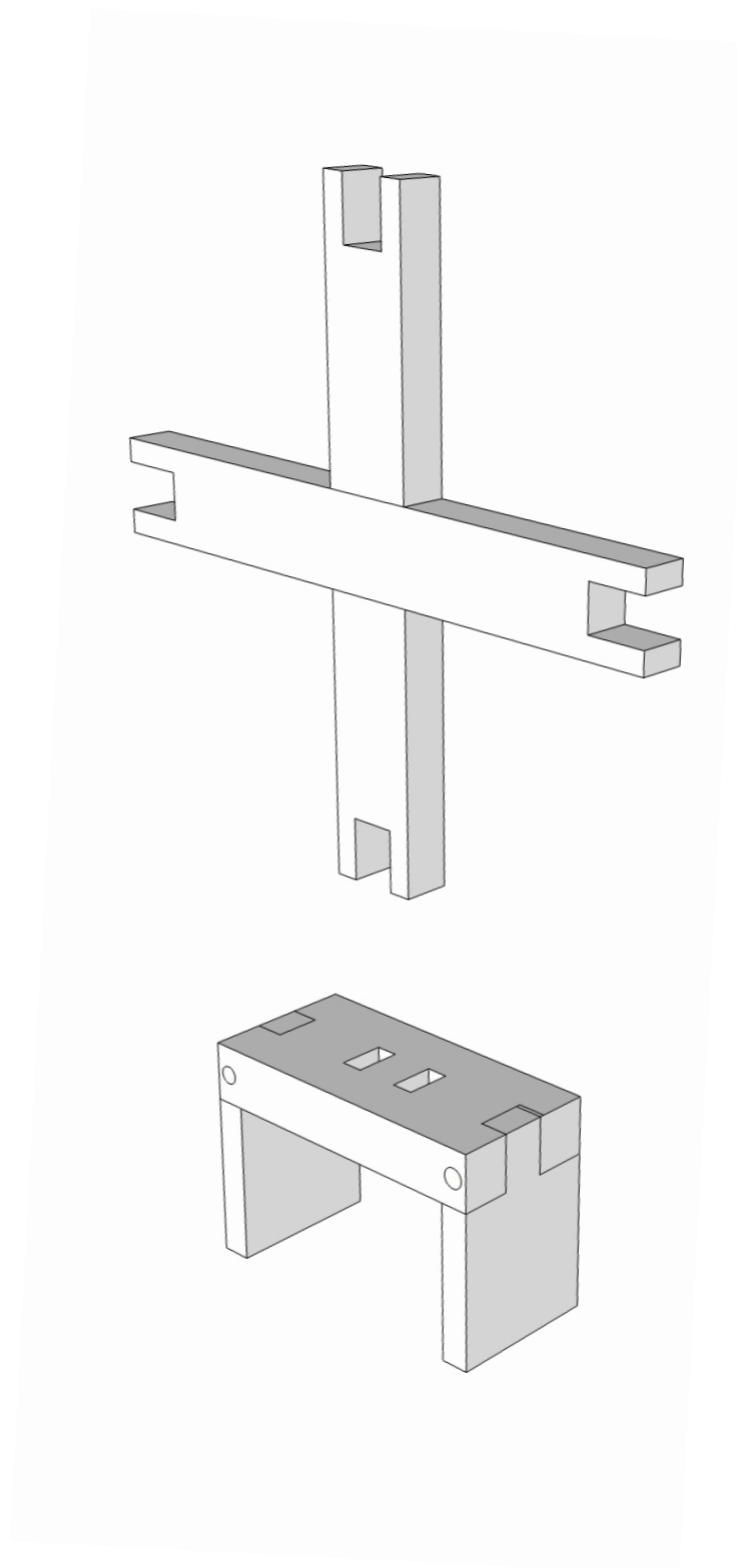
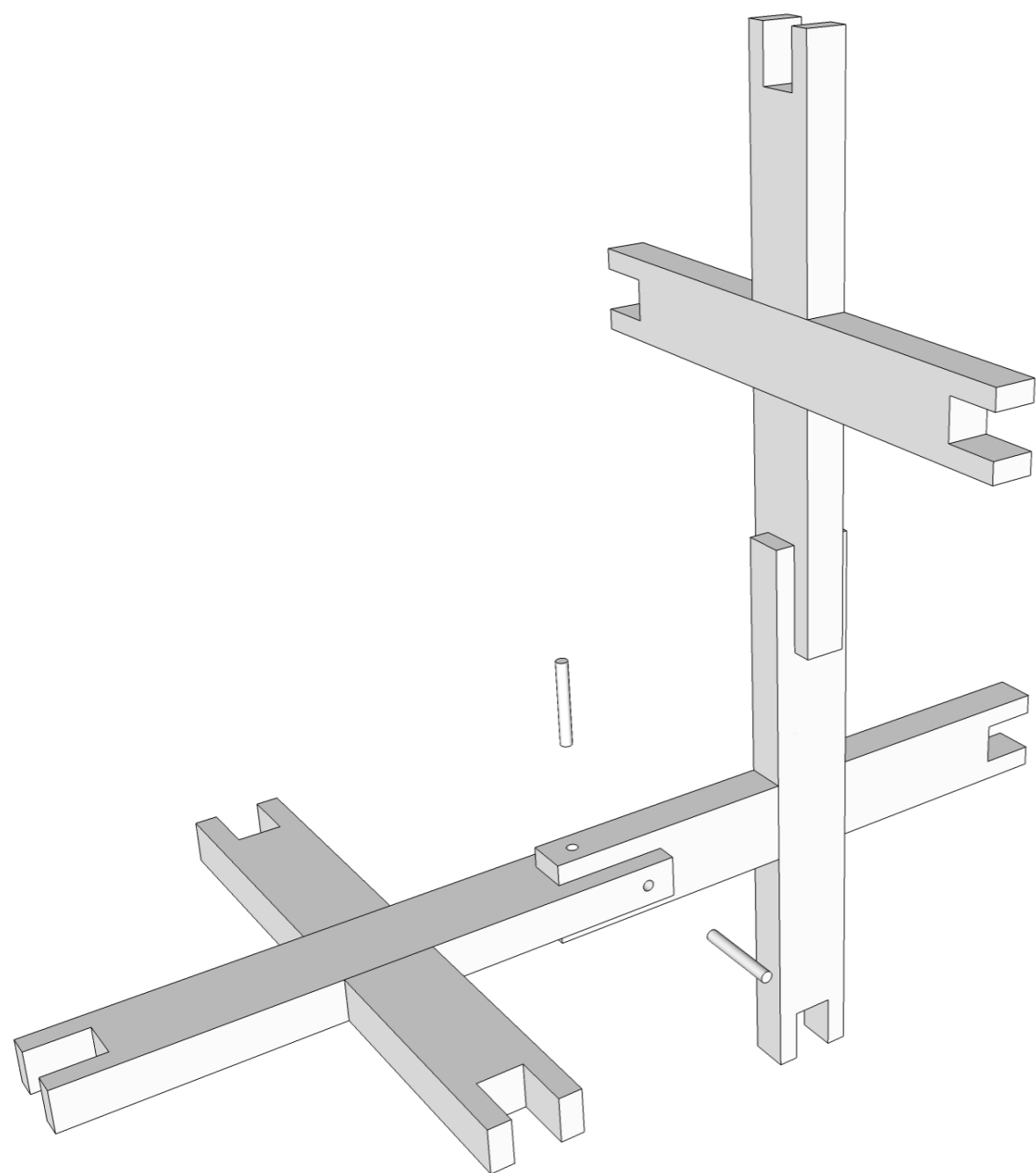

*Choix constructif : structure 100% bois avec ni vis, ni clous, ni colle*

BARTH Vincent BALLESTER Julia COTTON Ines CRUELLS Renaud DURAND Thomas KHAUV Daniel	MARTÍNEZ PÉREZ Pol MESTRE Antoine NIU Chenxiang LIER Keryann PIHAN Juliette	M. LEYRAL - F. MARTINET <b>Sculpture Technotnique 2017/18</b>
		<b>CAB'RILLE</b>

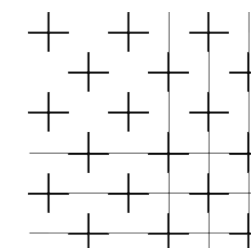

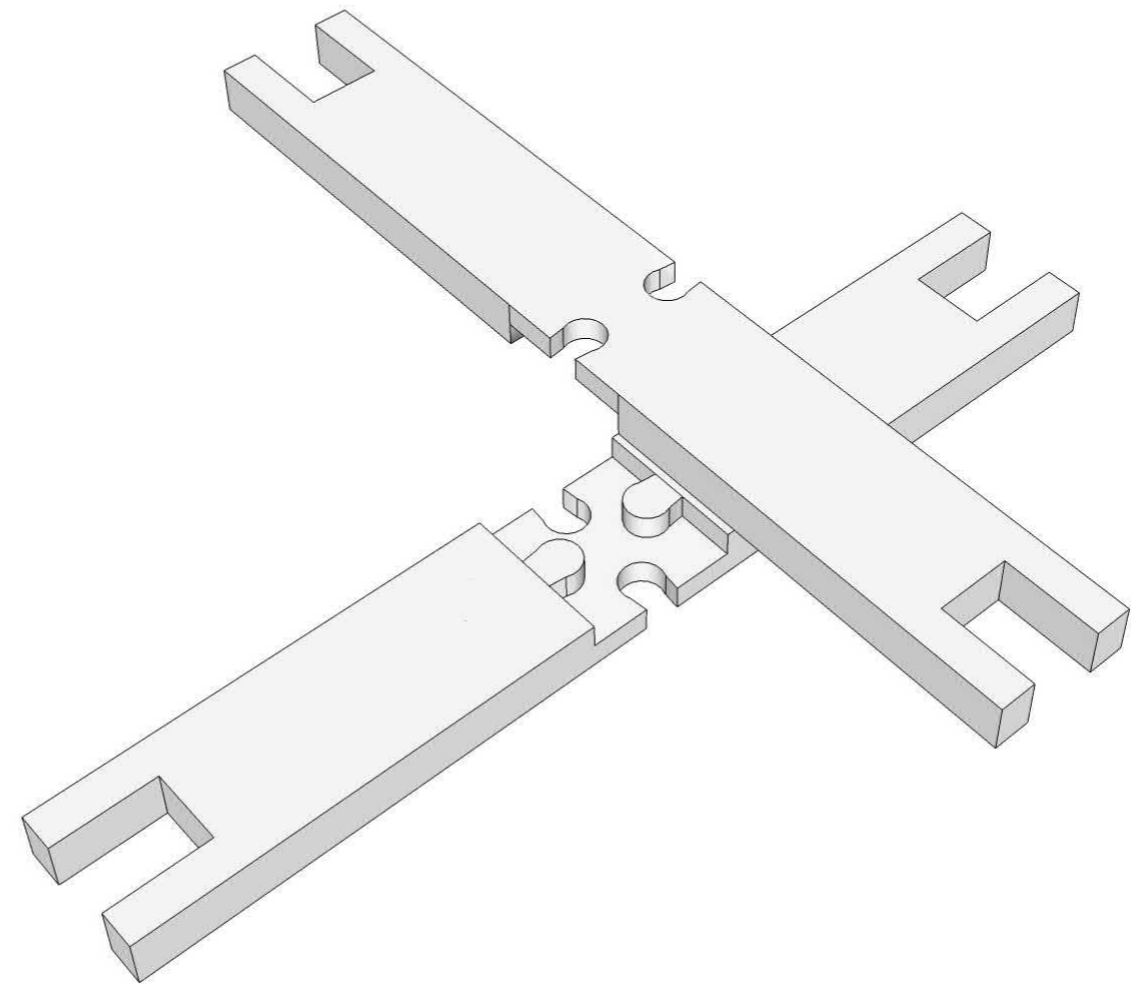
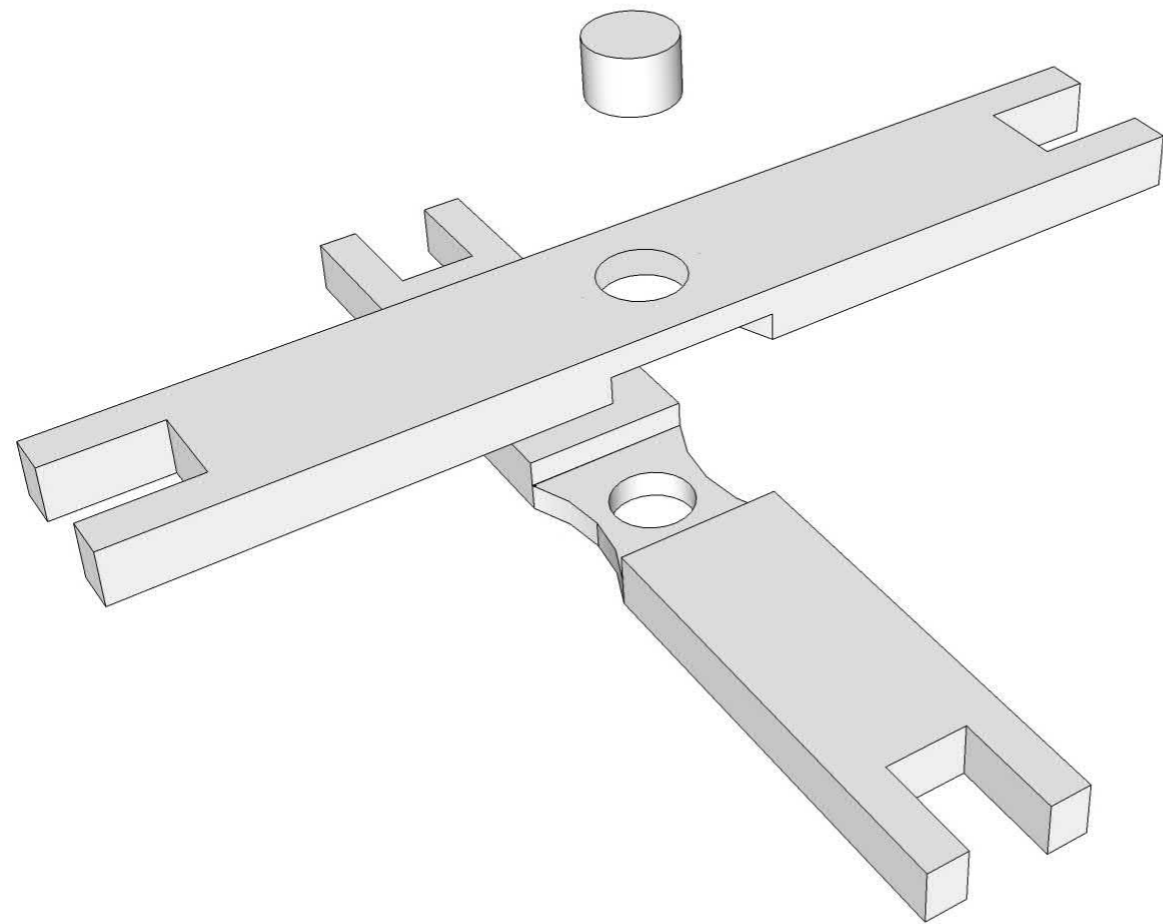

*Choix constructif : structure 100% bois avec ni vis, ni clous, ni colle*

BARTH Vincent BALLESTER Julia COTTON Ines CRUELLS Renaud DURAND Thomas KHAUV Daniel	MARTÍNEZ PÉREZ Pol MESTRE Antoine NIU Chenxiang LIER Keryann PIHAN Juliette	M. LEYRAL - F. MARTINET <b>Sculpture Technotnique 2017/18</b>
		<b>CAB'RILLE</b>

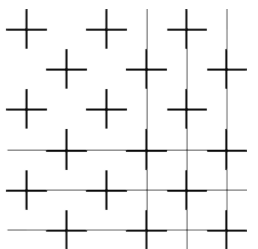



DÉTAIL QUANTITATIF ESTIMATIF (DQE)		CAB'RILLE				
	DÉSIGNATION DES TRAVAUX	U	Q	PU HT	Montant HT	Temps de pose
<b>1.</b>	<b>TRAVAUX PRÉPARATOIRES</b>					
100	Panneau de chantier	u	1,00		non chiffré	
101	Plans et documents d'EXE	ft	1,00		non chiffré	
102	VISA d'un bureau de contrôle agréé	ft	1,00	1 500,00 €	1 500,00 €	
103	Implantation	ft	1,00		non chiffré	
104	Plans et dossiers de récolement	ft	1,00		non chiffré	
105	Libération des emprises existantes	m <sup>2</sup>			non chiffré	
	<b>SOUS TOTAL - TRAVAUX PRÉPARATOIRES</b>				<b>1 500,00</b>	
<b>2.</b>	<b>CONSTRUCTION EN BOIS (FOURNITURES)</b>					
200	Solivage : solives 70/180 en bois de pin CL4	m	150,00	9,00 €	1 350,00 €	0,25 h/m <sup>2</sup> de plancher, soit 12,5 heures de pose
201	Pieds de croix : planches assemblées en bois de pin CL4	u	90,00	0,75 €	67,50 €	
202	Cales du plancher : planches assemblées en bois de pin CL4	u	90,00	0,75 €	67,50 €	
203	Plancher : panneau en bois de pin CL4, ép. 40	m <sup>2</sup>	50,00	25,00 €	1 250,00 €	
204	Croix : planche 22/90 en bois de pin CL4	u	3 055,00	0,50 €	1 527,50 €	0,003 h/unité de croix, soit 9 heures de pose
	<b>SOUS TOTAL -CONSTRUCTION EN BOIS (FOURNITURES)</b>				<b>2 735,00</b>	
<b>1.</b>	<b>TRAVAUX PRÉPARATOIRES</b>				<b>1 500,00</b>	
<b>2.</b>	<b>CONSTRUCTION EN BOIS (FOURNITURES)</b>				<b>2 735,00</b>	
	<b>MONTANT TOTAL :</b>				<b>4 235,00 €</b>	<b>22 heures de montage</b>

### Organisation du chantier

BARTH Vincent BALLESTER Julia COTTON Ines CRUELLES Renaud DURAND Thomas KHAUV Daniel	MARTÍNEZ PÉREZ Pol MESTRE Antoine NIU Chenxiang LIER Keryann PIHAN Juliette	M. LEYRAL - F. MARTINET <b>Sculpture Technotnique 2017/18</b>
		<b>CAB'RILLE</b>

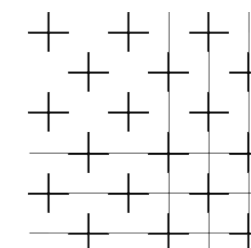

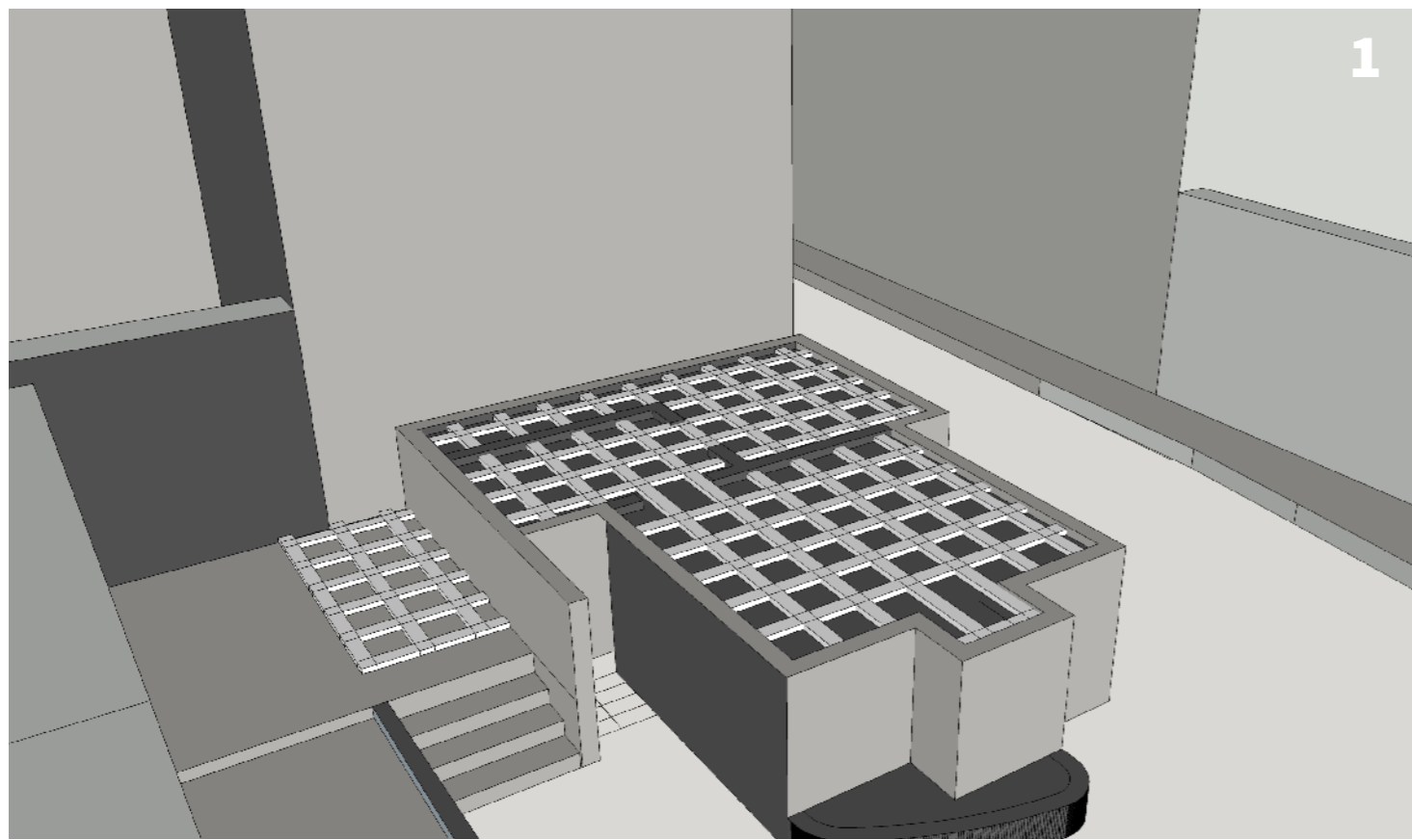

1

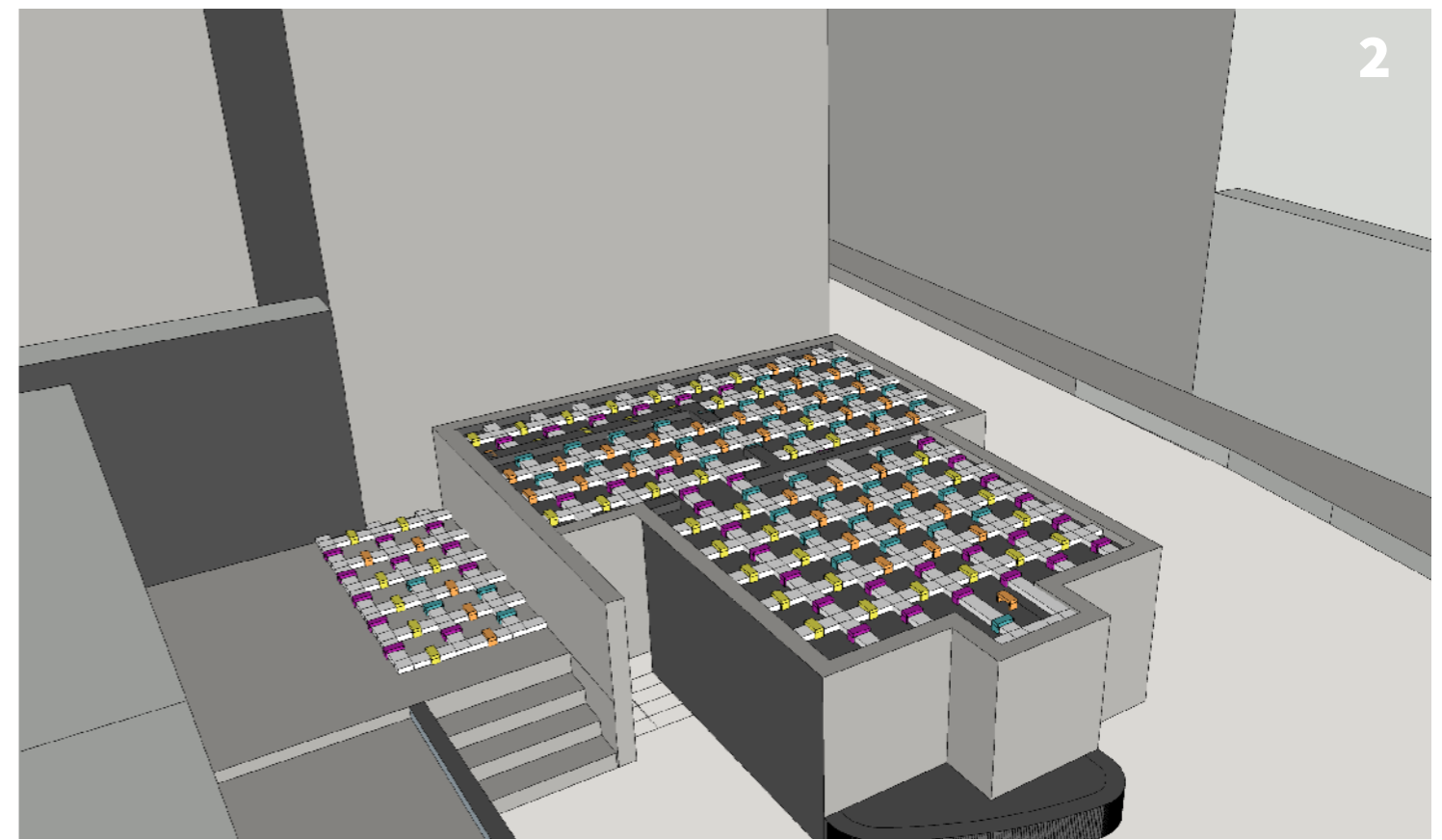

2

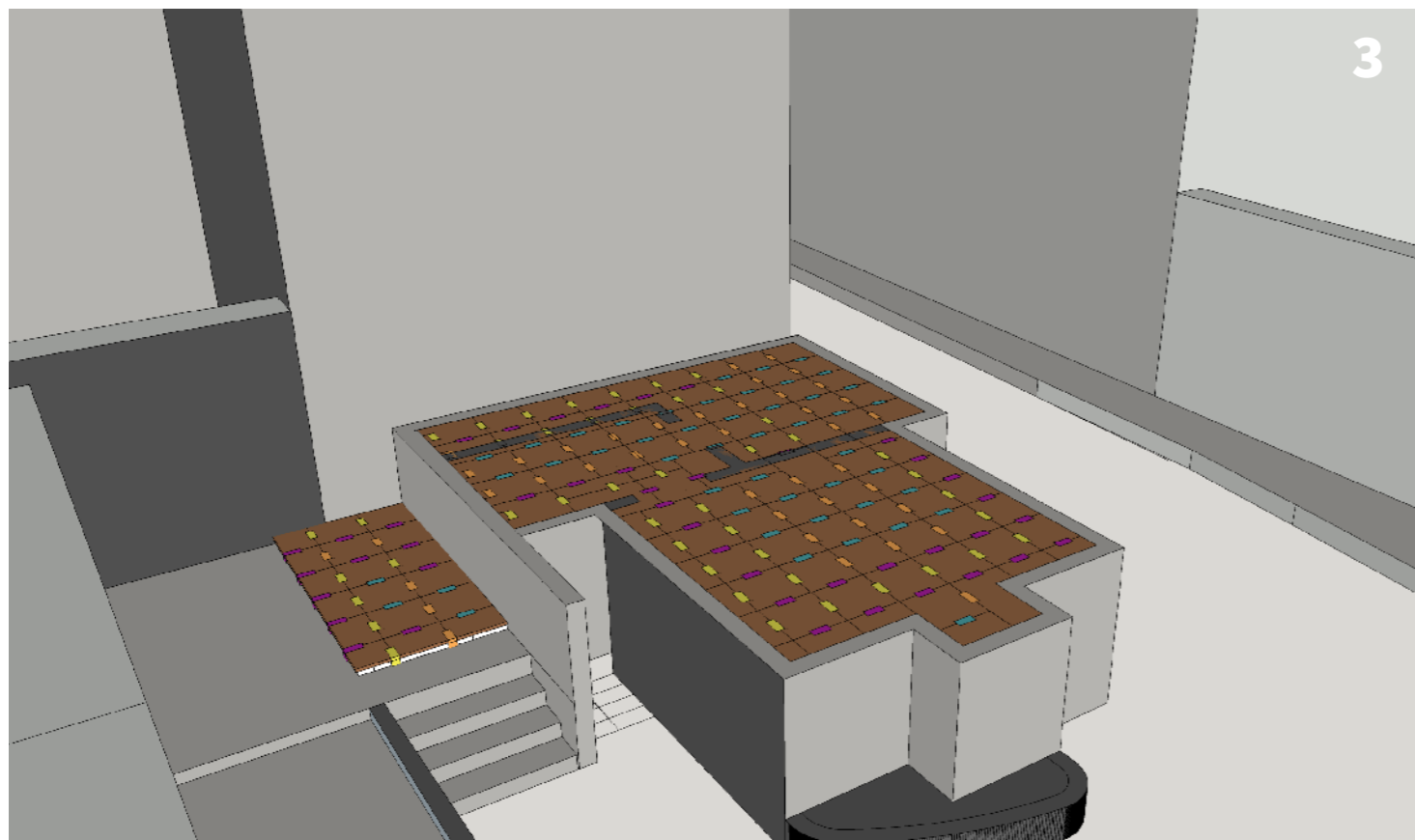

3

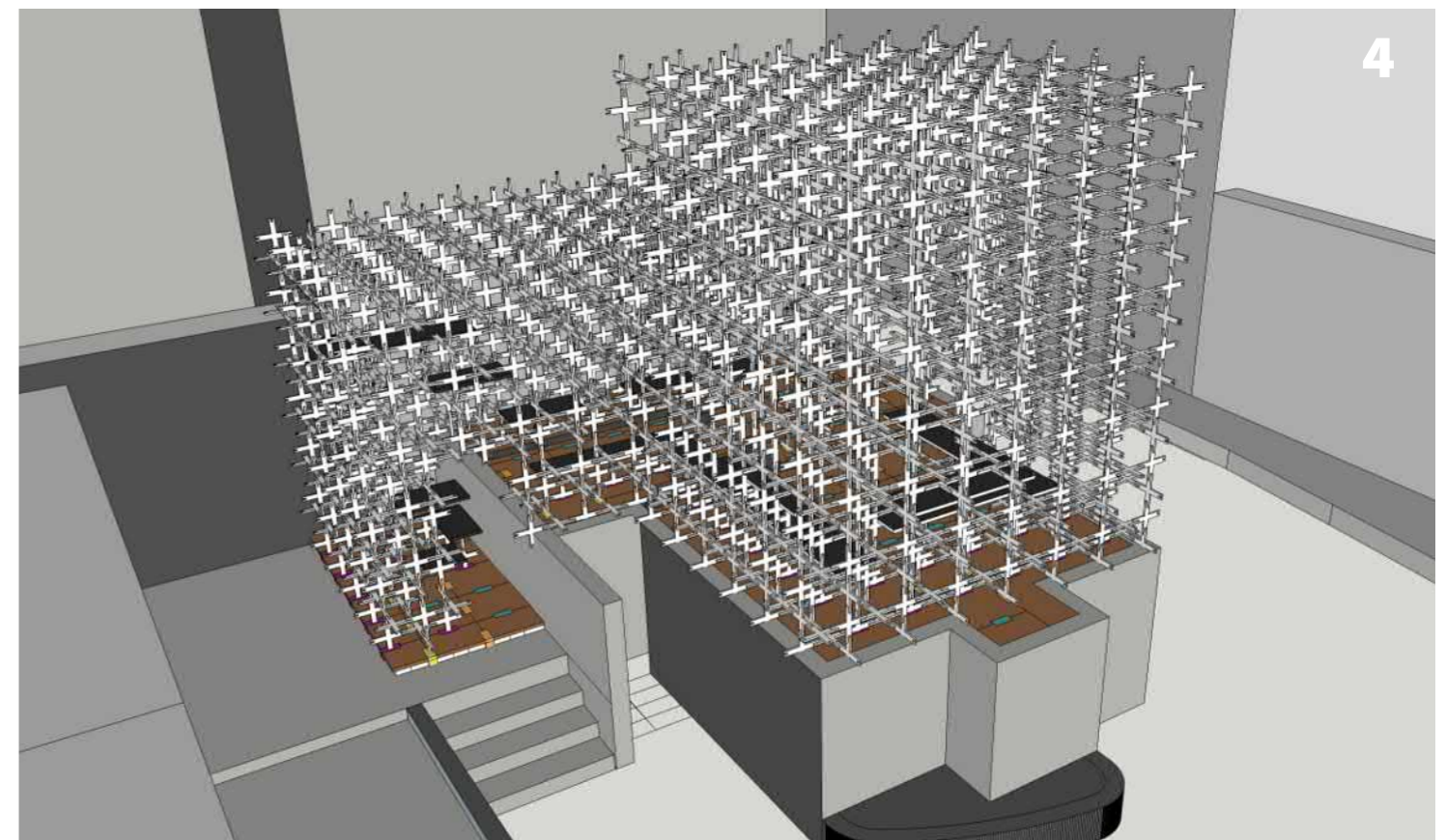

4

1. Solives

3. Plancher

2. Pieds

4. Ossature et assises

*Organisation du chantier*

BARTH Vincent BALLESTER Julia COTTON Ines CRUELLES Renaud DURAND Thomas KHAUV Daniel	MARTÍNEZ PÉREZ Pol MESTRE Antoine NIU Chenxiang LIER Keryann PIHAN Juliette	M. LEYRAL - F. MARTINET <b>Sculpture Technotnique 2017/18</b>
		<b>CAB'RILLE</b>

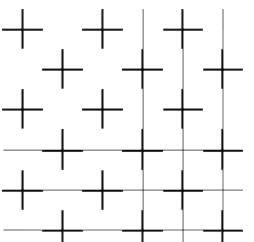



VIENS APPORTER TA CROIX À L'ÉDIFICE !

CAB' RILLE





Pavillon britannique de l'exposition universelle de Milan, 2014

BUTTRESS architectes

BARTH Vincent  
 BALLESTER Julia  
 COTTON Ines  
 CRUELLS Renaud  
 DURAND Thomas  
 KHAUV Daniel

MARTÍNEZ PÉREZ Pol  
 MESTRE Antoine  
 NIU Chenxiang  
 LIER Keryann  
 PIHAN Juliette

M. LEYRAL - F. MARTINET  
**Sculpture Technotique 2017/18**

**CAB'RILLE**

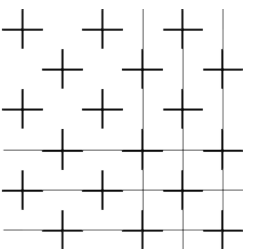



Prostho museum research  
KENGO KUMA architecte

BARTH Vincent BALLESTER Julia COTTON Ines CRUELLES Renaud DURAND Thomas KHAUV Daniel	MARTÍNEZ PÉREZ Pol MESTRE Antoine NIU Chenxiang LIER Keryann PIHAN Juliette	M. LEYRAL - F. MARTINET <b>Sculpture Technotnique 2017/18</b>
		<b>CAB'RILLE</b>

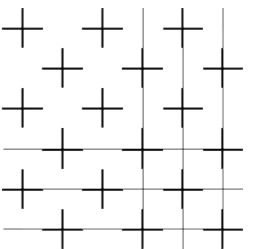



Serpentine pavillon  
 SOU FUJIMOTO architecte

BARTH Vincent BALLESTER Julia COTTON Ines CRUELLS Renaud DURAND Thomas KHAUV Daniel	MARTÍNEZ PÉREZ Pol MESTRE Antoine NIU Chenxiang LIER Keryann PIHAN Juliette	M. LEYRAL - F. MARTINET <b>Sculpture Technotnique 2017/18</b>
		<b>CAB'RILLE</b>

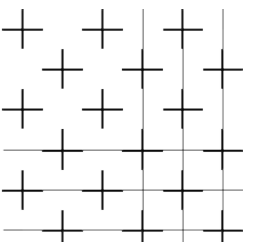

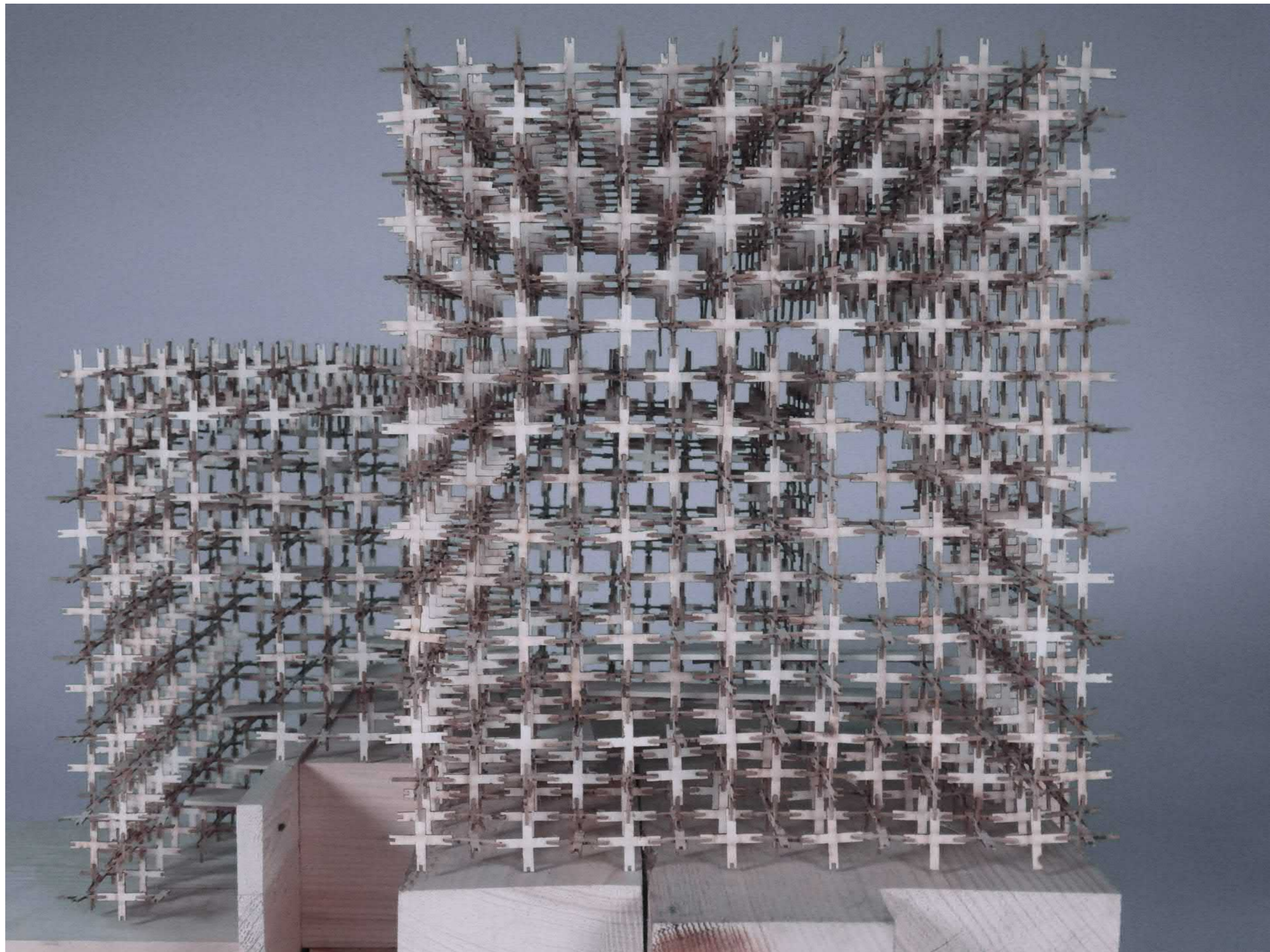

BARTH Vincent  
BALLESTER Julia  
COTTON Ines  
CRUELLS Renaud  
DURAND Thomas  
KHAUV Daniel

MARTÍNEZ PÉREZ Pol  
MESTRE Antoine  
NIU Chenxiang  
LIER Keryann  
PIHAN Juliette

M. LEYRAL - F. MARTINET  
**Sculpture Technotnique 2017/18**

**CAB'RILLE**

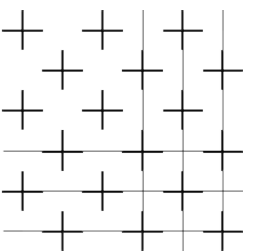

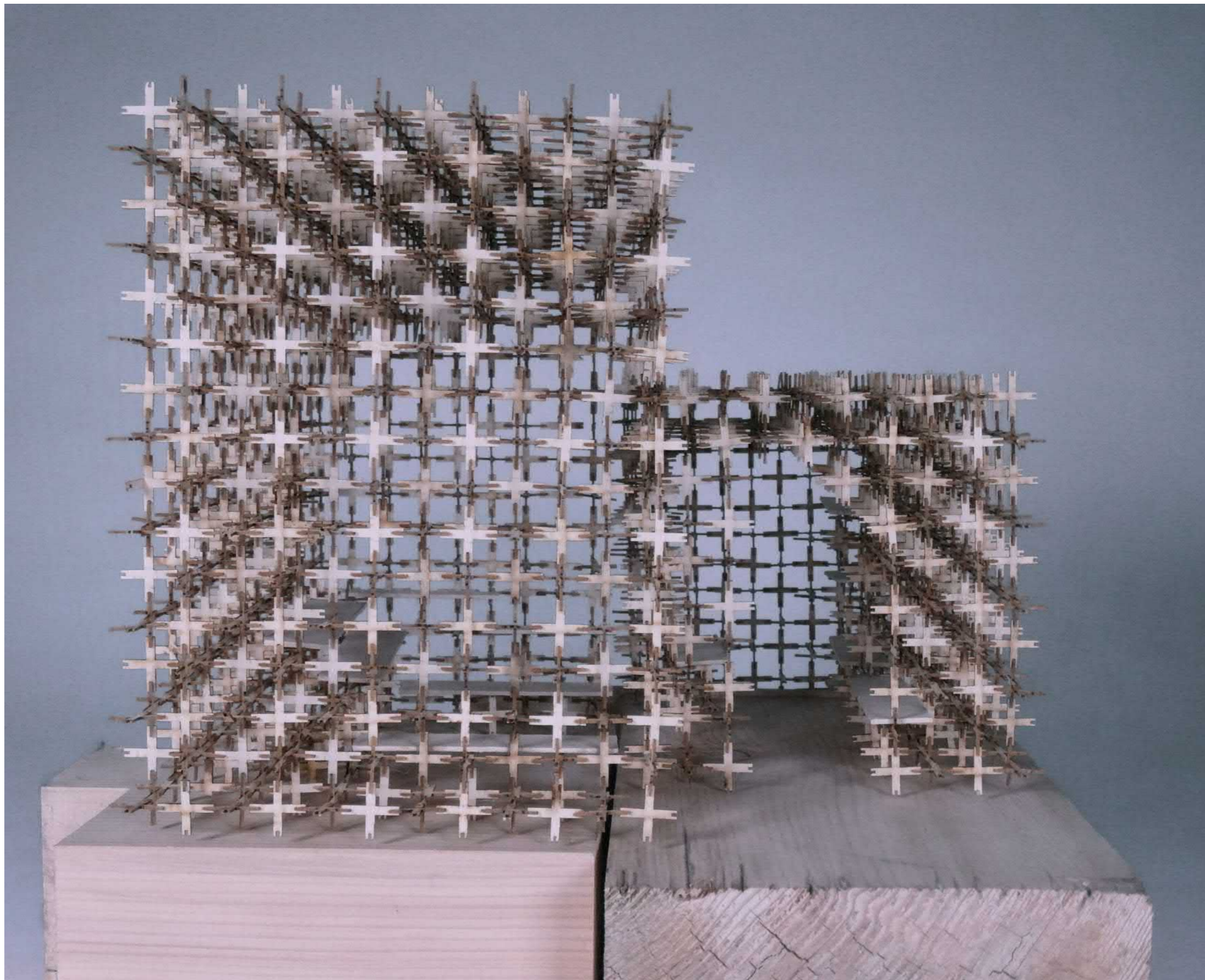

BARTH Vincent  
BALLESTER Julia  
COTTON Ines  
CRUELLS Renaud  
DURAND Thomas  
KHAUV Daniel

MARTÍNEZ PÉREZ Pol  
MESTRE Antoine  
NIU Chenxiang  
LIER Keryann  
PIHAN Juliette

M. LEYRAL - F. MARTINET  
**Sculpture Technotnique 2017/18**

**CAB'RILLE**

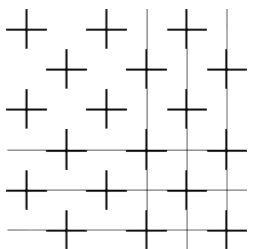



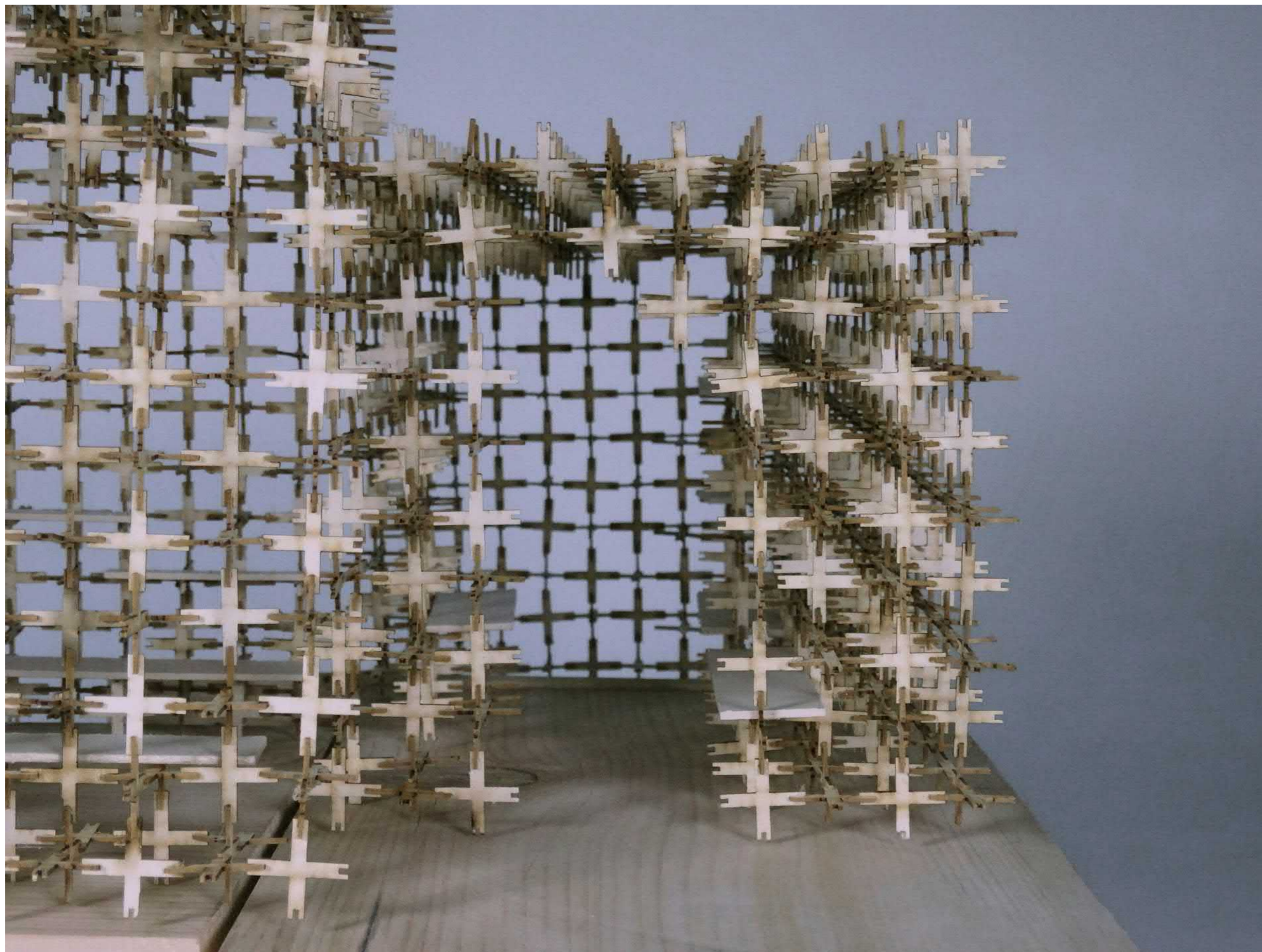

BARTH Vincent  
BALLESTER Julia  
COTTON Ines  
CRUELLS Renaud  
DURAND Thomas  
KHAUV Daniel

MARTÍNEZ PÉREZ Pol  
MESTRE Antoine  
NIU Chenxiang  
LIER Keryann  
PIHAN Juliette

M. LEYRAL - F. MARTINET  
**Sculpture Technotnique 2017/18**

**CAB'RILLE**

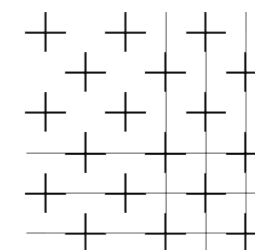

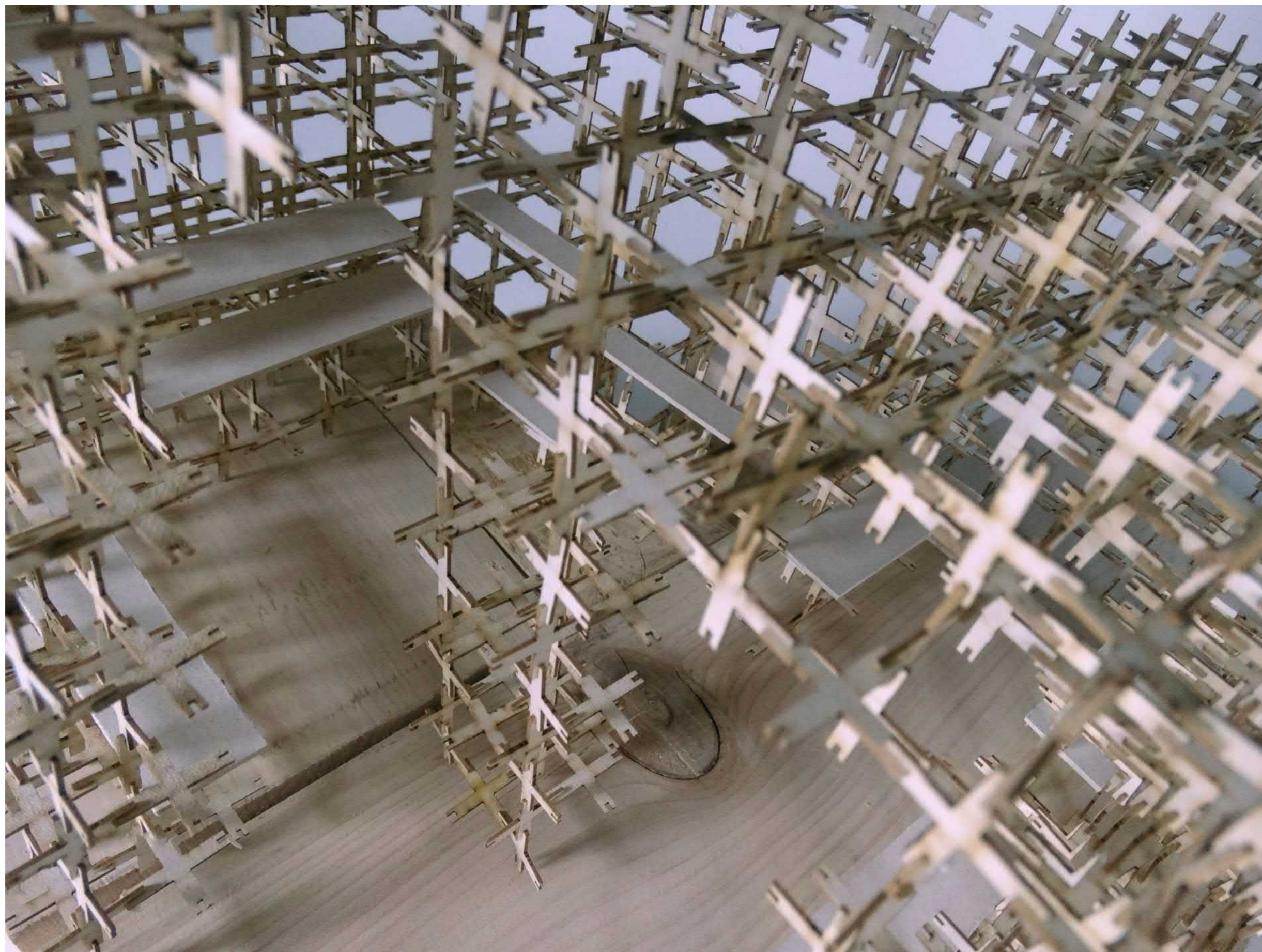

BARTH Vincent  
BALLESTER Julia  
COTTON Ines  
CRUELLS Renaud  
DURAND Thomas  
KHAUV Daniel

MARTÍNEZ PÉREZ Pol  
MESTRE Antoine  
NIU Chenxiang  
LIER Keryann  
PIHAN Juliette

M. LEYRAL - F. MARTINET  
**Sculpture Technotnique 2017/18**

**CAB'RILLE**

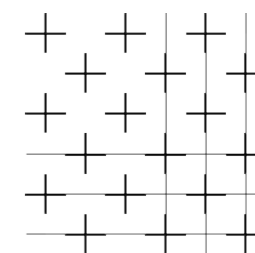



BARTH Vincent  
BALLESTER Julia  
COTTON Ines  
CRUELLS Renaud  
DURAND Thomas  
KHAUV Daniel

MARTÍNEZ PÉREZ Pol  
MESTRE Antoine  
NIU Chenxiang  
LIER Keryann  
PIHAN Juliette

M. LEYRAL - F. MARTINET  
**Sculpture Technotnique 2017/18**

**CAB'RILLE**

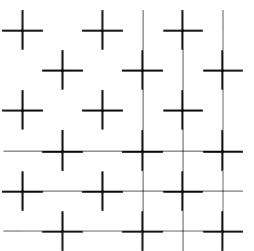

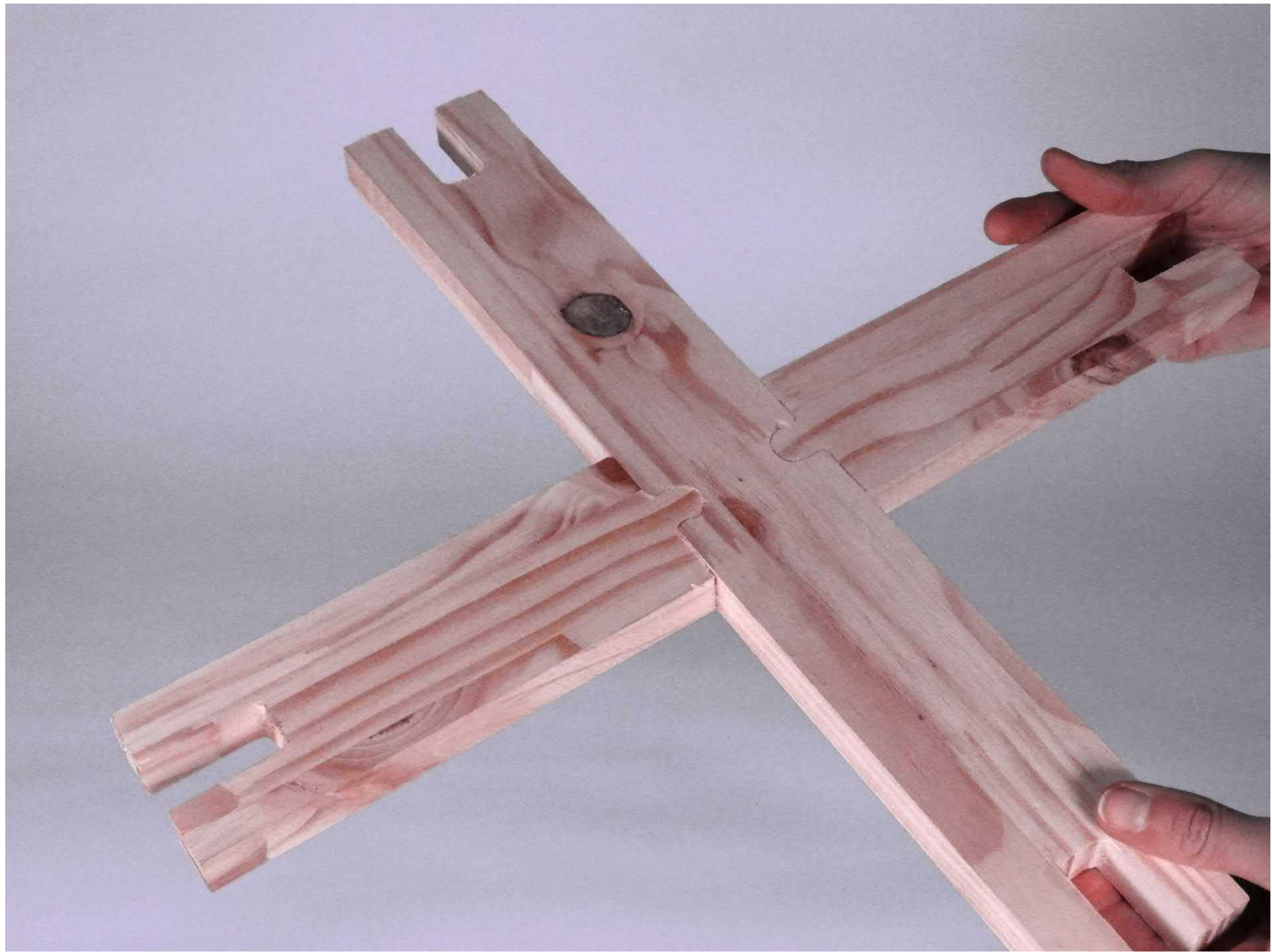

BARTH Vincent  
BALLESTER Julia  
COTTON Ines  
CRUELLS Renaud  
DURAND Thomas  
KHAUV Daniel

MARTÍNEZ PÉREZ Pol  
MESTRE Antoine  
NIU Chenxiang  
LIER Keryann  
PIHAN Juliette

M. LEYRAL - F. MARTINET  
**Sculpture Technotnique 2017/18**

**CAB'RILLE**

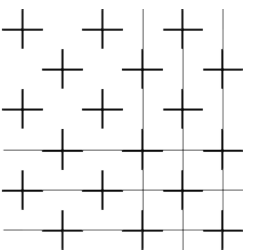

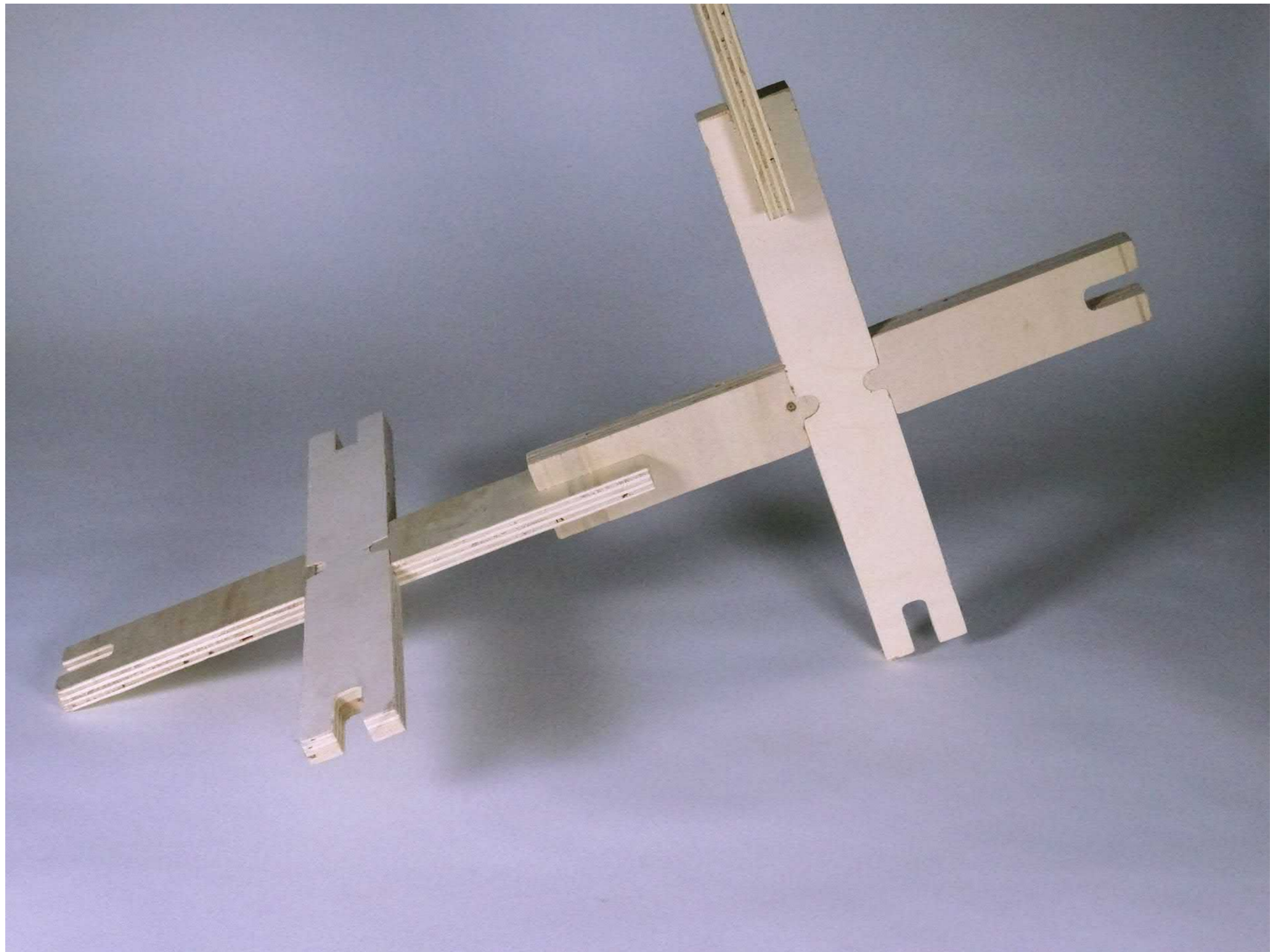

BARTH Vincent  
BALLESTER Julia  
COTTON Ines  
CRUELLS Renaud  
DURAND Thomas  
KHAUV Daniel

MARTÍNEZ PÉREZ Pol  
MESTRE Antoine  
NIU Chenxiang  
LIER Keryann  
PIHAN Juliette

M. LEYRAL - F. MARTINET  
**Sculpture Technotnique 2017/18**

**CAB'RILLE**

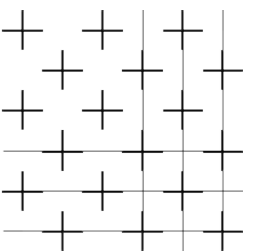

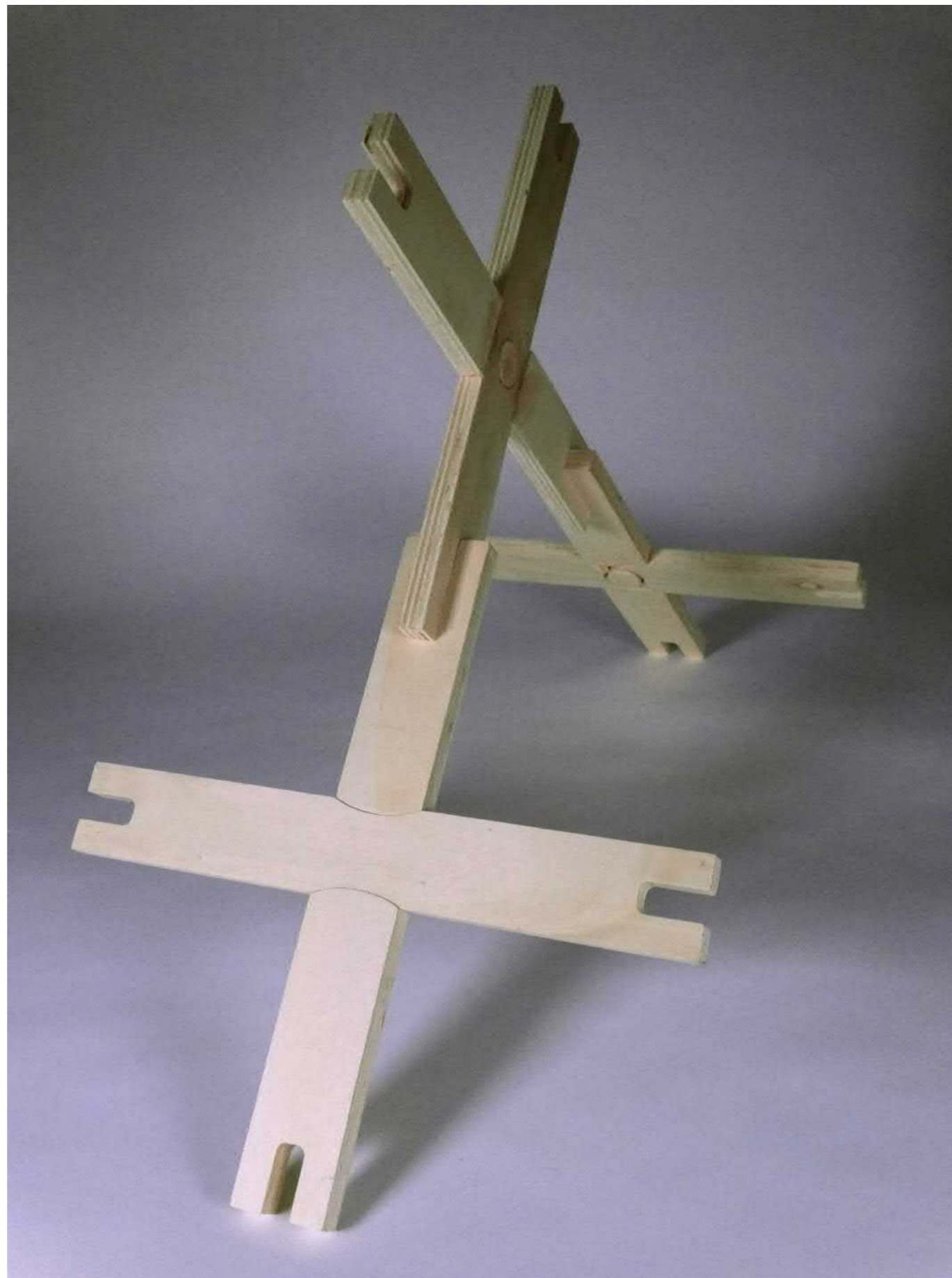

BARTH Vincent  
BALLESTER Julia  
COTTON Ines  
CRUELLS Renaud  
DURAND Thomas  
KHAUV Daniel

MARTÍNEZ PÉREZ Pol  
MESTRE Antoine  
NIU Chenxiang  
LIER Keryann  
PIHAN Juliette

M. LEYRAL - F. MARTINET  
**Sculpture Technotnique 2017/18**

**CAB'RILLE**

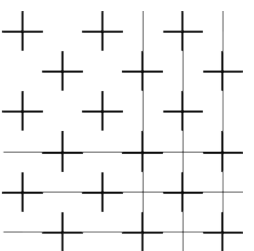

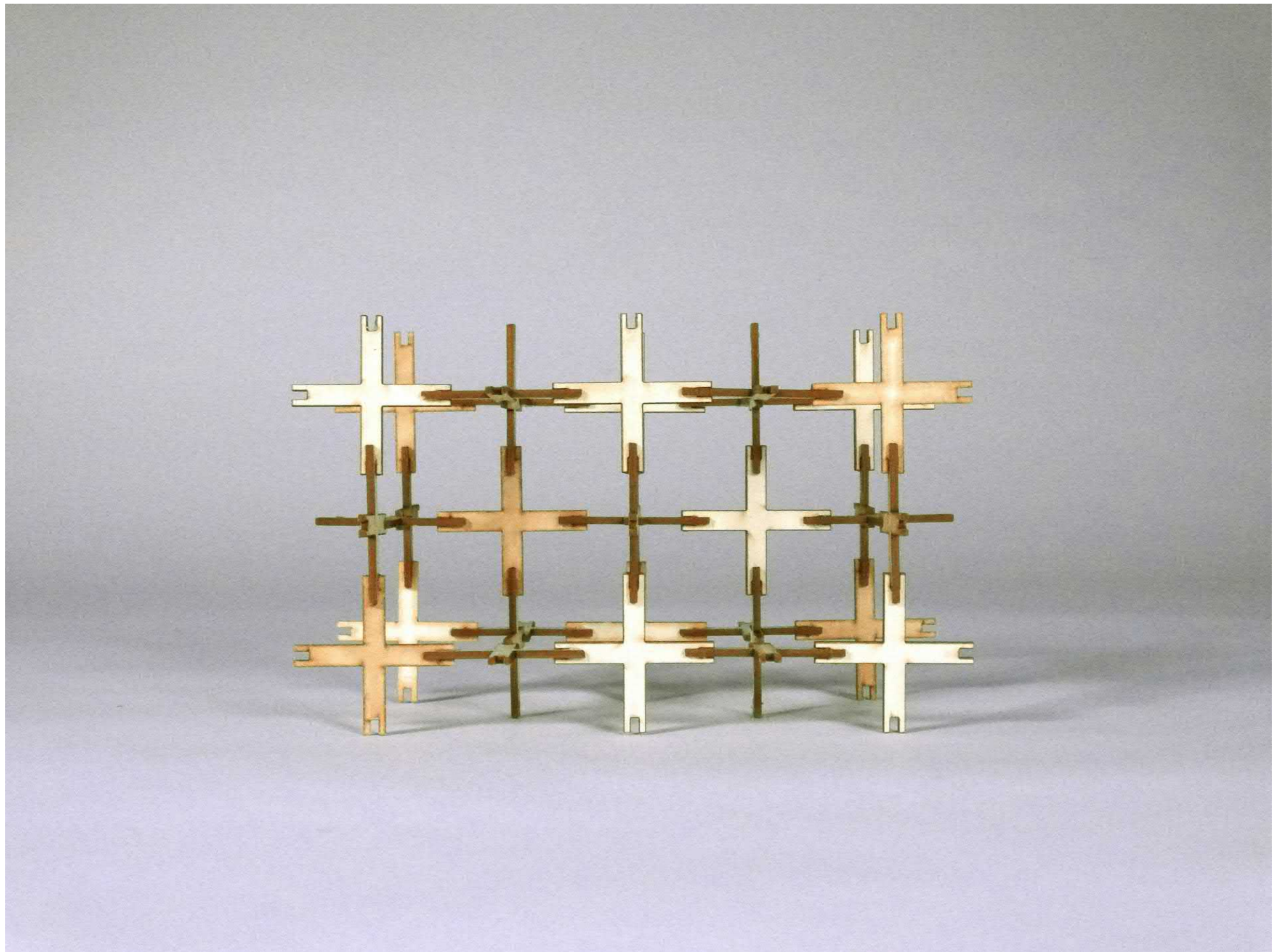

BARTH Vincent BALLESTER Julia COTTON Ines CRUELLES Renaud DURAND Thomas KHAUV Daniel	MARTÍNEZ PÉREZ Pol MESTRE Antoine NIU Chenxiang LIER Keryann PIHAN Juliette	M. LEYRAL - F. MARTINET <b>Sculpture Technotnique 2017/18</b>
		<b>CAB'RILLE</b>

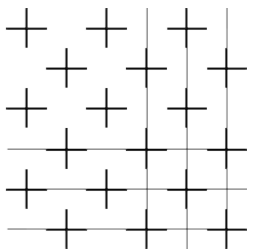

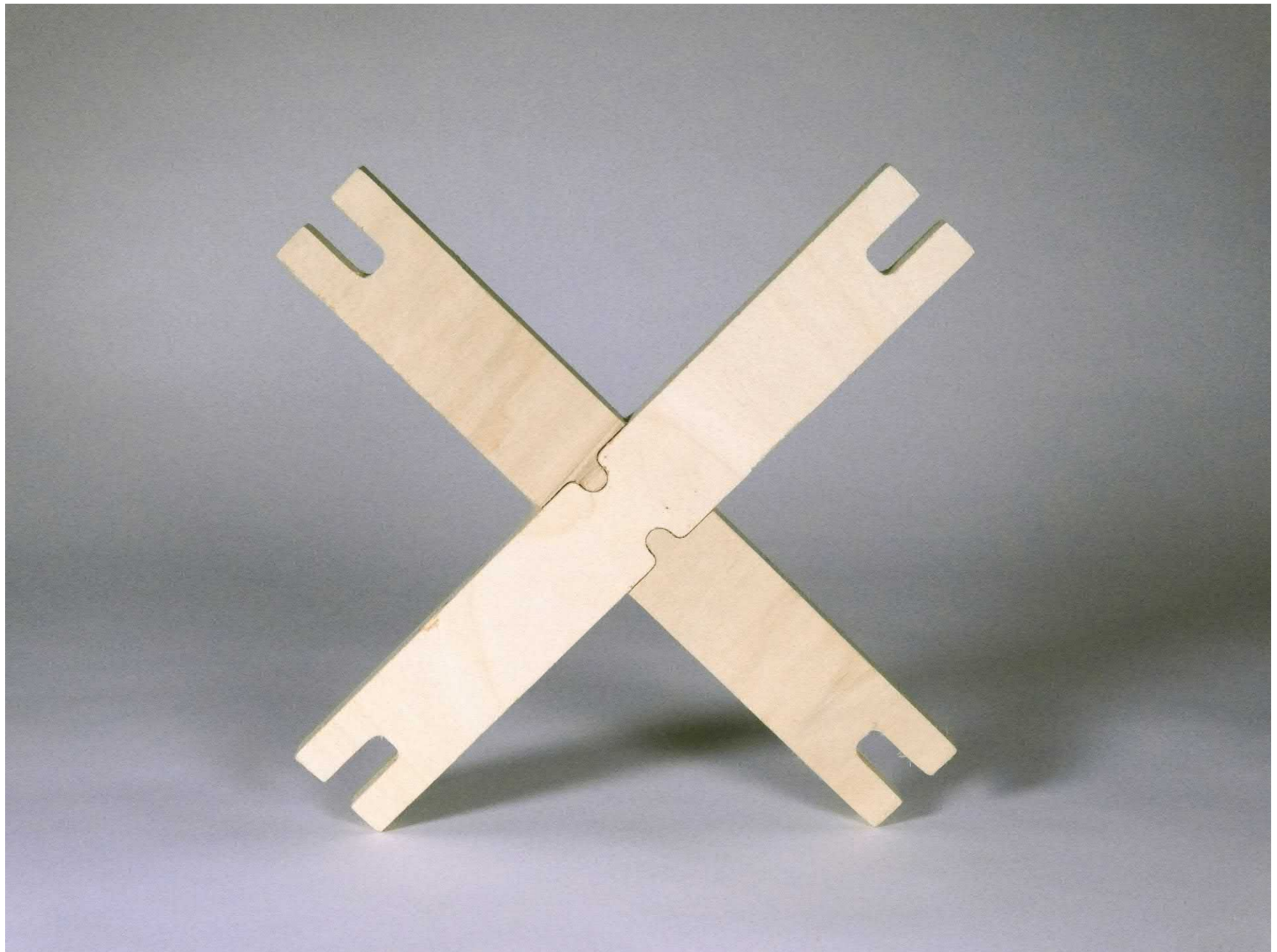

BARTH Vincent  
BALLESTER Julia  
COTTON Ines  
CRUELLS Renaud  
DURAND Thomas  
KHAUV Daniel

MARTÍNEZ PÉREZ Pol  
MESTRE Antoine  
NIU Chenxiang  
LIER Keryann  
PIHAN Juliette

M. LEYRAL - F. MARTINET  
**Sculpture Technotnique 2017/18**

**CAB'RILLE**

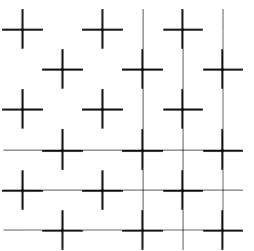





BARTH Vincent  
BALLESTER Julia  
COTTON Ines  
CRUELLS Renaud  
DURAND Thomas  
KHAUV Daniel

MARTÍNEZ PÉREZ Pol  
MESTRE Antoine  
NIU Chenxiang  
LIER Keryann  
PIHAN Juliette

M. LEYRAL - F. MARTINET  
**Sculpture Technotnique 2017/18**

**CAB'RILLE**

